

INSTALLATION INSTRUCTIONS

57-2523-2

Ford

Mustang Cobra
1996-99, 2001 V8-4.6L DOHC

Mustang Bullitt
2001 V8-4.6L SOHC

TOOLS NEEDED:

flat blade screwdriver
phillips screwdriver
8mm wrench
10mm wrench
5mm allen wrench
ratchet
socket extension
8mm socket
pair of vise grips
drill
3/16" drill bit

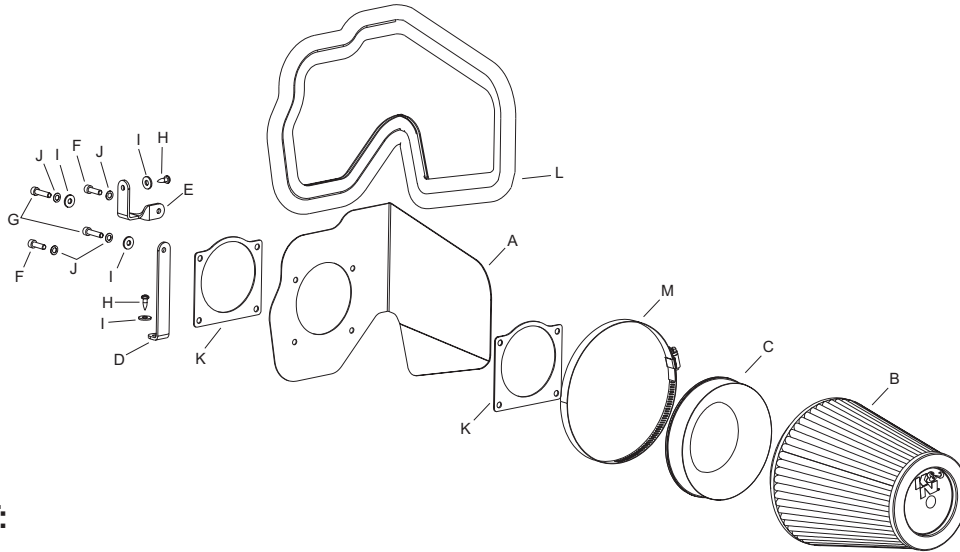

PARTS LIST:

A	Heat Shield	1	07421	F	6mm-1.00 x 20mm Allen Bolt	2	07852	K	Gasket	2	09984
B	Filtercharger Element	1	RF-1048	G	6mm-1.00 x 25mm Allen Bolt	2	07859	L	Trim Seal 44"L	1	102486
C	Adapter	1	08785	H	Sheet Metal Screw	2	07788	M	Hose Clamp #104	1	08697
D	"L" Bracket	1	07089	I	Flat Washer	4	08275				
E	"L" Twist Bracket	1	07954	J	Wave Washer	4	08174				

TO START:

1. Turn the ignition OFF and disconnect the vehicle's negative battery cable.

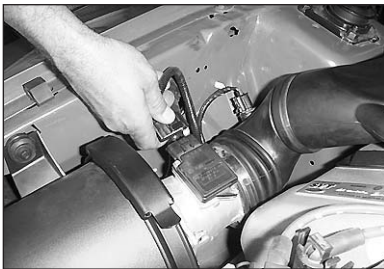

2. Disconnect the mass air sensor electrical connections.



3. Loosen the hose clamp on the intake tube at the mass air sensor.



4. Loosen and remove the bolt that retains the air cleaner assembly.



5. Pull the air cleaner assembly upward and remove from vehicle.



6. Loosen and remove the four nuts that retain the mass-air sensor to the air cleaner.

NOTE: It may be necessary to use a pair of vise grips to hold the studs while loosening the nuts.



7. Remove the mass air sensor from the air cleaner.

NOTE: The screen will not be used.



8. Assemble the mass air sensor, adapter, gaskets and brackets using the hardware provided.



9. Install the mass air assembly into the intake tube.



10. Align the brackets to the inner fender and lower fender then mark.



11. Remove the mass air assembly from the vehicle and using a 3/16" drill bit, drill out the two marks.



12. Install the trim seal onto the heat shield.

13. Reinstall the mass air assembly into the intake tube and secure the brackets with the sheet metal screws provided.

14. Tighten the hose clamp on the intake tube at the mass air sensor.



15. Install the filtercharger element onto the adapter and secure it with the hose clamp provided.

16. Reconnect the mass air sensor electrical connection.

17. Reconnect the vehicle's negative battery cable. Double check to make sure everything is tight and properly positioned before starting the vehicle.

18. The C.A.R.B. exemption sticker, (attached), must be visible under the hood, so that an emissions inspector can see it when the vehicle is required to be tested for emissions. California requires testing every two years, other states may vary.

19. It will be necessary for all FIPK's to be checked periodically for realignment, clearance and tightening of all connections. Failure to follow the above instructions or proper maintenance may void warranty.

ROAD TESTING:

1. Start the engine with the transmission in neutral or park, and the parking brake engaged. Listen for air leaks or odd noises. For air leaks secure hoses and connections. For odd noises, find cause and repair before proceeding. This kit will function identically to the factory system except for being louder and much more responsive.

2. Test drive the vehicle. Listen for odd noises or rattles and fix as necessary.

3. If road test is fine, you can now enjoy the added power and performance from your kit.

4. K&N suggests checking the Filtercharger element periodically for excessive dirt build-up. When the element becomes covered in dirt (or once a year), service it according to the instructions on the Recharger service kit, part number 99-5050 or 99-5000.

FREE K&N DECAL To register your warranty, please see us online at knfilters.com/register. FREE K&N DECAL